

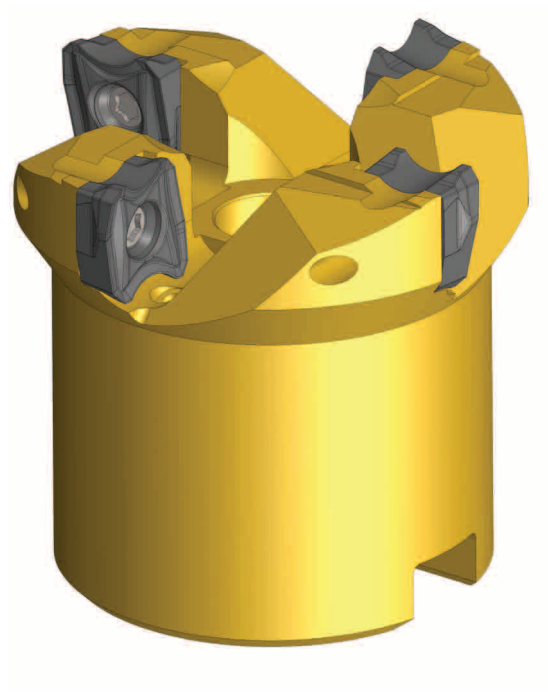





HEAD-Master[®]

C



FELIX 2020

Der Universelle Helixfräser
The universal Helical milling

| Typ Type | Serie Series | Darstellung Figure | WSP Insert | Größe Size | Seite Page | Typ Type | Serie Series | Darstellung Figure | WSP Insert | Größe Size | Seite Page |
|--|-----------------|---|--|---------------|---------------|-------------|-----------------|-----------------------|---------------|---------------|---------------|
| Power-Mould Zirkularfräser Powermould Helixcutter | 5015-T W-W |  | ACLX 0607.. ACHX 0607.. ACLX 0910.. ACHX 0910.. | Ø16 - Ø30 | 402 | | | | | | |
| | 5020-T E-W |  | ACLX 0607.. ACHX 0607.. ACLX 0910.. ACHX 0910.. | Ø14 - Ø42 | 403 | | | | | | |
| | 5025-T M-W |  | ACLX 0910.. ACHX 0910.. | Ø35 - Ø50 | 404 | | | | | | |
| | 5026-T |  | ACLX 0607.. ACHX 0607.. ACLX 0910.. ACHX 0910.. | Ø14 - Ø66 | 405 | | | | | | |
| Spannwerkzeuge Clamp tools | 5125 |  | | | 406 | | | | | | |
| | | | | | | | | | | | |
| | | | | | | | | | | | |
| | | | | | | | | | | | |

C

Serie 5015 - Power-Mould Zirkularfräser



Series 5015 - Powermould Helixcutter

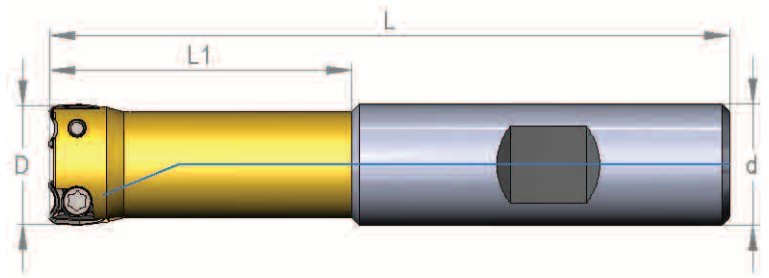

- Ausführung:** Helix-Schafffräser, mit Innenkühlung mit hoher Verschleißfestigkeit und Korrosionsbeständigkeit
- Lieferumfang:** ohne Wendeschneidplatten, ohne Schraubendreher
- Anwendung:** zum Bohrungs- und Nutenfräsen, Auskoffern, universelle Einsatzmöglichkeit
- Execution:** Helical milling cutter, with inner coolant with high wear resistance and corrosion resistance
- Delivery:** without insert, without screwdriver
- Application:** for boring-holes pockets, universal application



Schafffräser (Shoulder milling cutter)

| Bestell-Nr.: Order Code: | Abmessungen / Dimension (mm) | | | | | | Wendeplatte Insert  | Schraube Screw  | Schlüssel Key  |
|-----------------------------|------------------------------|----|---------------|----|-----|----|---|---|--|
| | Z | D | Dmin- Dmax | L1 | L | d | | | |
| 5015-T MHN 16-2WW | 2 | 16 | 22-30 | 45 | 90 | 16 | ACLX / ACHX 0607.. | TS2 | M-BT07 |
| 5015-T MHN 23-3WW | 3 | 23 | 30-46 | 45 | 95 | 20 | ACLX / ACHX 0910.. | TS3 | M-BT09 |
| 5015-T MHN 30-3WW | 3 | 30 | 44-60 | 50 | 100 | 25 | | | |

Bestellbeispiel / Orderexample: 5015-T MHN 16-2WW

M-BT07 = 0,9 Nm
M-BT09 = 1,4 Nm

| Form Figure  | Abmessungen Dimensions | | | | | Bezeichnung Designation | Schraube | Schlüssel | Unbeschichtet Sorten Uncoated grades | | Beschichtet Sorten coated grades | | | | | |
|--|------------------------|-------|------|------|---|----------------------------|----------|-----------|---|--------------|-------------------------------------|---------|-------|-------|-------|-------|
| | l | d | s | d1 | r | | | | CT28 | K10 | PTT20 | PTV28 | PTT35 | PAP28 | MTM10 | KTE20 |
| | ACHX.. ACLX | 7,35 | 6,30 | 3,20 | | | | | | ACHX 0607 .. | TS2 | M-BT 07 | ■ | | | ■ |
| | 10,60 | 10,60 | 4,16 | | | ACHX 0910.. | TS3 | M-BT 09 | ■ | | | ■ | ■ | | ■ | ■ |
| | 7,35 | 6,30 | 3,2 | | | ACLX 0607.. | TS2 | M-BT 07 | ■ | | | ■ | ■ | | ■ | ■ |
| | 10,60 | 10,60 | 4,16 | | | ACLX 0910.. | TS3 | M-BT 09 | ■ | | | ■ | ■ | | ■ | ■ |

Serie 5020 - Power-Mould Zirkularfräser Series 5020 - Powermould Helixcutter



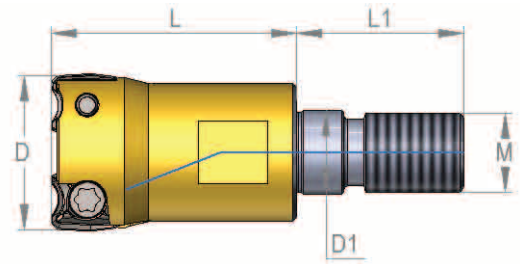

Ausführung: Helix-Einschraubfräser, mit Innenkühlung mit hoher Verschleißfestigkeit und Korrosionsbeständigkeit
Lieferumfang: ohne Wendeschneidplatten, ohne Schraubendreher
Anwendung: zum Bohrungs- und Nutenfräsen, Auskoffern, universelle Einsatzmöglichkeit

Execution: Helical threaded Type cutter, with inner coolant with high wear resistance and corrosion resistance
Delivery: without insert, without screwdriver
Application: for boring-holes pockets, universal application



Einschraubfräser (Threaded type milling cutter)

| Bestell-Nr.: Order Code: | Abmessungen / Dimension (mm) | | | | | | Wendeplatte Insert  | Schraube Screw  | Schlüssel Key  |
|-----------------------------|------------------------------|----|---------------|------|----|-----|---|---|--|
| | Z | D | Dmin- Dmax | L1 | L | M | | | |
| 5020-T MHN 14-2EW | 2 | 14 | 16-25 | 14,5 | 25 | M6 | ACLX / ACHX 0607.. | TS2 0,9 Nm | M-BT07 |
| 5020-T MHN 16-2EW | 2 | 16 | 22-30 | 17 | 25 | M8 | | | |
| 5020-T MHN 18-3EW | 3 | 18 | 25-35 | 17 | 25 | M8 | | | |
| 5020-T MHN 23-3EW | 3 | 23 | 30-46 | 20 | 30 | M10 | ACLX / ACHX 0910.. | TS3 1,4 Nm | M-BT09 |
| 5020-T MHN 30-3EW | 3 | 30 | 44-60 | 22 | 35 | M12 | | | |
| 5020-T MHN 38-4EW | 4 | 38 | 60-76 | 24 | 43 | M16 | | | |

Bestellbeispiel / Orderexample: 5020-T MHN 14-2EW
 Verlängerungen siehe Seite 392 - 400

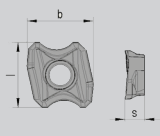
| Form Figure | Abmessungen Dimensions | | | | | Bezeichnung Designation | Schraube | Schlüssel | Unbeschichtet Sorten Uncoated grades | | Beschichtet Sorten coated grades | | | | | | |
|--|---|-------|-------|------|---|----------------------------|--------------|-----------|---|-----|-------------------------------------|-------|-------|-------|-------|-------|---|
| | l | d | s | d1 | r | | | | CT28 | K10 | PTT20 | PTV28 | PTT35 | PAP28 | MTM10 | KTE20 | |
|  ACHX.. ACLX |  | | | | | | | | | | | | | | | | |
| | | 7,35 | 6,30 | 3,20 | | | ACHX 0607 .. | TS2 | M-BT 07 | ■ | | | ■ | ■ | | ■ | ■ |
| | | 10,60 | 10,60 | 4,16 | | | ACHX 0910.. | TS3 | M-BT 09 | ■ | | | ■ | ■ | | ■ | ■ |
| | | 7,35 | 6,30 | 3,2 | | | ACLX 0607.. | TS2 | M-BT 07 | ■ | | | ■ | ■ | | ■ | ■ |
| | | 10,60 | 10,60 | 4,16 | | | ACLX 0910.. | TS3 | M-BT 09 | ■ | | | ■ | ■ | | ■ | ■ |

C

Serie 5025 - Power-Mould Zirkularfräser

Series 5025 - Powermould Helixcutter



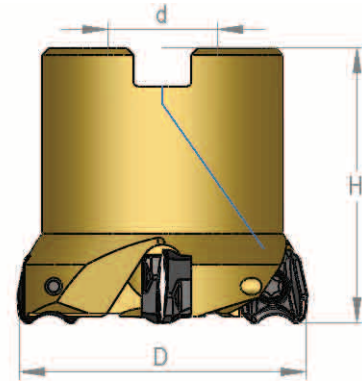

Ausführung: Helix-Aufsteckfräser, mit Innenkühlung mit hoher Verschleißfestigkeit und Korrosionsbeständigkeit
Lieferumfang: ohne Wendeschneidplatten, ohne Schraubendreher
Anwendung: zum Bohrungs- und Nutenfräsen, Auskoffern, universelle Einsatzmöglichkeit

Execution: Helical Shellcopy milling cutter, with inner coolant with high wear resistance and corrosion resistance
Delivery: without insert, without screwdriver
Application: for boring-holes pockets, universal application



Aufsteckfräser (Shell copy milling cutter)

| Bestell-Nr.: Order Code: | Abmessungen / Dimension (mm) | | | | | Wendepatte Insert  | Schraube Screw  | Schlüssel Key  |
|-----------------------------|------------------------------|----|-----------|----|----|---|--|---|
| | Z | D | Dmin-Dmax | H | d | | | |
| 5025-T MHN 35-3MW | 3 | 35 | 54-70 | 40 | 16 | ACLX / ACHX 0910.. | TS3 1,4 Nm | M-BT09 |
| 5025-T MHN 42-4MW | 4 | 42 | 68-84 | 40 | 16 | | | |
| 5025-T MHN 50-5MW | 5 | 50 | 84-100 | 40 | 22 | | | |

Bestellbeispiel / Orderexample: 5025-T MHN 35-3MW

| Form Figure  | Abmessungen Dimensions | | | | | Bezeichnung Designation | Schraube | Schlüssel | Unbeschichtet Sorten Uncoated grades | | Beschichtet Sorten coated grades | | | | | |
|--|------------------------|-------|------|------|---|----------------------------|----------|-----------|---|--------------|-------------------------------------|---------|-------|-------|-------|-------|
| | l | d | s | d1 | r | | | | CT28 | K10 | PTT20 | PTV28 | PTT35 | PAP28 | MTM10 | KTE20 |
| | ACHX.. ACLX | 7,35 | 6,30 | 3,20 | | | | | | ACHX 0607 .. | TS2 | M-BT 07 | ■ | | | ■ |
| | 10,60 | 10,60 | 4,16 | | | ACHX 0910.. | TS3 | M-BT 09 | ■ | | | ■ | ■ | | ■ | ■ |
| | 7,35 | 6,30 | 3,2 | | | ACLX 0607.. | TS2 | M-BT 07 | ■ | | | ■ | ■ | | ■ | ■ |
| | 10,60 | 10,60 | 4,16 | | | ACLX 0910.. | TS3 | M-BT 09 | ■ | | | ■ | ■ | | ■ | ■ |

C

Serie 5026 - System Power-Mould Zirkularfräser

Series 5026 - System Powermould Helixcutter



Ausführung: Helix-Schaftfräser, mit Innenkühlung mit hoher Verschleißfestigkeit und Korrosionsbeständigkeit
Ab Größe 3 mit Hartmetallkern
(schwingungsgedämpfte Eigenschaften)

Lieferumfang: ohne Wendeschneidplatten, ohne Schraubendreher



Anwendung: zum Bohrungs- und Nutenfräsen, Auskoffern, universelle Einsatzmöglichkeit

Execution: Helical milling cutter, with inner coolant with high wear resistance and corrosion resistance
From size 3 with solid carbide core
(anti vibration properties)

Delivery: without insert, without screwdriver

Application: for boring-holes pockets, universal application



| Bestell-Nr.: Order Code: | Abmessungen / Dimension (mm) | | | | | | | | Wendepatte Insert  | Schraube Screw  | Schlüssel Key  |
|-----------------------------|------------------------------|--------------|----|-------|-----|-----|----|---|--|---|--|
| | D | Dmin Dmax | D1 | Syst. | L | L1 | SA | Z | | | |
| 5026-T MHN 14-2.1 | 14 | 16-25 | 48 | D24 | 77 | 55 | SK | 2 | ACLX / ACHX 0607.. | TS2 0,9 Nm | M-BT07 |
| 5026-T MHN 14-2.2 | 14 | 16-25 | 48 | D24 | 107 | 85 | SK | 2 | | | |
| 5026-T MHN 14-2.3 | 14 | 16-25 | 48 | D24 | 122 | 105 | HK | 2 | | | |
| 5026-T MHN 14-2.4 | 14 | 16-25 | 48 | D24 | 147 | 125 | HK | 2 | | | |
| 5026-T MHN 16-2.1 | 16 | 22-30 | 48 | D24 | 77 | 55 | SK | 2 | | | |
| 5026-T MHN 16-2.2 | 16 | 22-30 | 48 | D24 | 107 | 85 | SK | 2 | | | |
| 5026-T MHN 16-2.3 | 16 | 22-30 | 48 | D24 | 122 | 105 | HK | 2 | | | |
| 5026-T MHN 16-2.4 | 16 | 22-30 | 48 | D24 | 147 | 125 | HK | 2 | | | |
| 5026-T MHN 18-3.1 | 18 | 24-34 | 48 | D24 | 77 | 55 | SK | 3 | | | |
| 5026-T MHN 18-3.2 | 18 | 24-34 | 48 | D24 | 107 | 85 | SK | 3 | | | |
| 5026-T MHN 18-3.3 | 18 | 24-34 | 48 | D24 | 122 | 105 | HK | 3 | | | |
| 5026-T MHN 18-3.4 | 18 | 24-34 | 48 | D24 | 147 | 125 | HK | 3 | | | |
| 5026-T MHN 23-3.1 | 23 | 30-46 | 48 | D24 | 82 | 60 | SK | 3 | | | |
| 5026-T MHN 23-3.2 | 23 | 30-46 | 48 | D24 | 112 | 90 | SK | 3 | | | |
| 5026-T MHN 23-3.3 | 23 | 30-46 | 48 | D24 | 152 | 130 | HK | 3 | | | |
| 5026-T MHN 23-3.4 | 23 | 30-46 | 48 | D24 | 192 | 170 | HK | 3 | | | |
| 5026-T MHN 30-3.1 | 30 | 44-60 | 48 | D24 | 97 | 75 | SK | 3 | | | |
| 5026-T MHN 30-3.2 | 30 | 44-60 | 48 | D24 | 137 | 115 | SK | 3 | | | |
| 5026-T MHN 30-3.3 | 30 | 44-60 | 48 | D24 | 157 | 135 | HK | 3 | | | |
| 5026-T MHN 30-3.4 | 30 | 44-60 | 48 | D24 | 207 | 185 | HK | 3 | | | |
| 5026-T MHN 38-4.1 | 38 | 60-76 | 48 | D24 | 105 | 83 | SK | 4 | | | |
| 5026-T MHN 38-4.2 | 38 | 60-76 | 48 | D24 | 145 | 123 | SK | 4 | | | |
| 5026-T MHN 38-4.3 | 38 | 60-76 | 48 | D24 | 165 | 143 | HK | 4 | | | |
| 5026-T MHN 38-4.4 | 38 | 60-76 | 48 | D24 | 215 | 193 | HK | 4 | | | |
| 5026-T MHN 44-5.1 | 44 | 72-88 | 48 | D24 | 102 | 80 | SK | 5 | | | |
| 5026-T MHN 44-5.2 | 44 | 72-88 | 48 | D24 | 145 | 120 | SK | 5 | | | |
| 5026-T MHN 44-5.3 | 44 | 72-88 | 48 | D24 | 202 | 180 | HK | 5 | | | |
| 5026-T MHN 44-5.4 | 44 | 72-88 | 48 | D24 | 242 | 220 | HK | 5 | | | |
| 5026-T MHN 50-6.1 | 50 | 84-100 | 48 | D24 | 97 | 75 | SK | 6 | | | |
| 5026-T MHN 50-6.2 | 50 | 84-100 | 48 | D24 | 147 | 125 | SK | 6 | | | |
| 5026-T MHN 50-6.3 | 50 | 84-100 | 48 | D24 | 202 | 180 | HK | 6 | | | |
| 5026-T MHN 50-6.4 | 50 | 84-100 | 48 | D24 | 272 | 250 | HK | 6 | | | |
| 5026-T MHN 58-6.1 | 58 | 100-116 | 48 | D24 | 97 | 75 | SK | 6 | | | |
| 5026-T MHN 58-6.2 | 58 | 100-116 | 48 | D24 | 147 | 125 | SK | 6 | | | |
| 5026-T MHN 58-6.3 | 58 | 100-116 | 48 | D24 | 202 | 180 | HK | 6 | | | |
| 5026-T MHN 58-6.4 | 58 | 100-116 | 48 | D24 | 272 | 250 | HK | 6 | | | |
| 5026-T MHN 66-8.2 | 66 | 116-132 | 75 | D42 | 134 | 132 | SK | 8 | | | |
| 5026-T MHN 66-8.3 | 66 | 116-132 | 75 | D42 | 220 | 198 | HK | 8 | | | |
| 5026-T MHN 66-8.4 | 66 | 116-132 | 75 | D42 | 286 | 264 | HK | 8 | | | |

Bestellbeispiel / Orderexample: 5026-T MHN 14-2.1

SA = Schaftausführung

SK = Stahlschaft / Steel shank

HK = Schaft mit Hartmetalleinsatz / Shank with carbide insert

C

Serie 5026 - System Power-Mould Zirkularfräser
Series 5026 - System Powermould Helixcutter

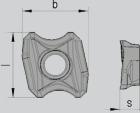

| | Form Figure | Abmessungen Dimensions | | | | | Bezeichnung Designation | Schraube | Schlüssel | Unbeschichtet Sorten Uncoated grades | | Beschichtet Sorten coated grades | | | | | |
|--|---|------------------------|-------|------|----|---|-------------------------|----------|-----------|---|-----|-------------------------------------|-------|-------|-------|-------|-------|
| | | l | d | s | d1 | r | | | | CT28 | K10 | PTT20 | PTV28 | PTT35 | PAP28 | MTM10 | KTE20 |
|  ACHX.. ACLX |  | 7,35 | 6,30 | 3,20 | | | ACHX 0607 .. | TS2 | M-BT 07 | ■ | | | ■ | ■ | | ■ | ■ |
| | | 10,60 | 10,60 | 4,16 | | | ACHX 0910.. | TS3 | M-BT 09 | ■ | | | ■ | ■ | | ■ | ■ |
| | | 7,35 | 6,30 | 3,2 | | | ACLX 0607.. | TS2 | M-BT 07 | ■ | | | ■ | ■ | | ■ | ■ |
| | | 10,60 | 10,60 | 4,16 | | | ACLX 0910.. | TS3 | M-BT 09 | ■ | | | ■ | ■ | | ■ | ■ |

Serie 5125 - Spannwerkzeuge
Series 5125 - Clamp tools

Ausführung: Spannwerkzeuge für Verlängerungen Typ 5120, 5118
Execution: Clamp tools for extensions Typ 5120, 5118

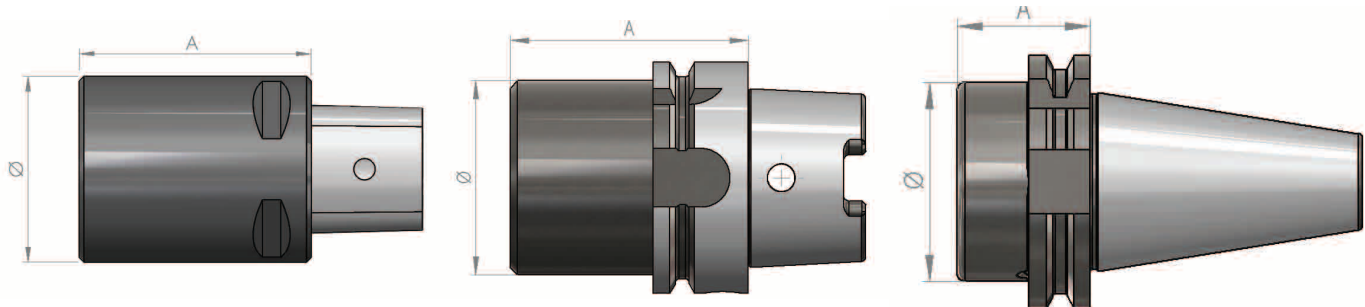

| Bestell-Nr.: Order Code: | Spannwerkzeuge mit innerer Kühlmittelzufuhr | | | |
|-----------------------------|---|--------|---------|------------|
| | Clamp tools with inner coolant | | | |
| 5125 SK40 D24 | DIN 69871 AD+B | Ø = 48 | A = 35 | System D24 |
| 5125 SK50 D24 | DIN 69871 AD+B | Ø = 48 | A = 35 | System D24 |
| 5125 SK50 D42 | DIN 69871 AD+B | Ø = 75 | A = 35 | System D42 |
| 5125 BT40 D24 | MAS-BT | Ø = 48 | A = 25 | System D24 |
| 5125 BT50 D24 | MAS-BT | Ø = 48 | A = 35 | System D24 |
| 5125 BT50 D42 | MAS-BT | Ø = 75 | A = 38 | System D42 |
| 5125 HSK-A 50 D24 | HSK | Ø = 48 | A = 65 | System D24 |
| 5125 HSK-A 63 D24 | HSK | Ø = 48 | A = 65 | System D24 |
| 5125 HSK-A 100 D24 | HSK | Ø = 48 | A = 100 | System D24 |
| 5125 HSK-A 100 D42 | HSK | Ø = 75 | A = 100 | System D42 |
| 5125 PSK63 | Polygon Aufnahme | Ø = 48 | A = 65 | System D24 |

Bestellbeispiel / Orderexample: 5125 SK40 D24
 D = Schnittstelle / Interface

C

Schruppvorgang / Roughing process

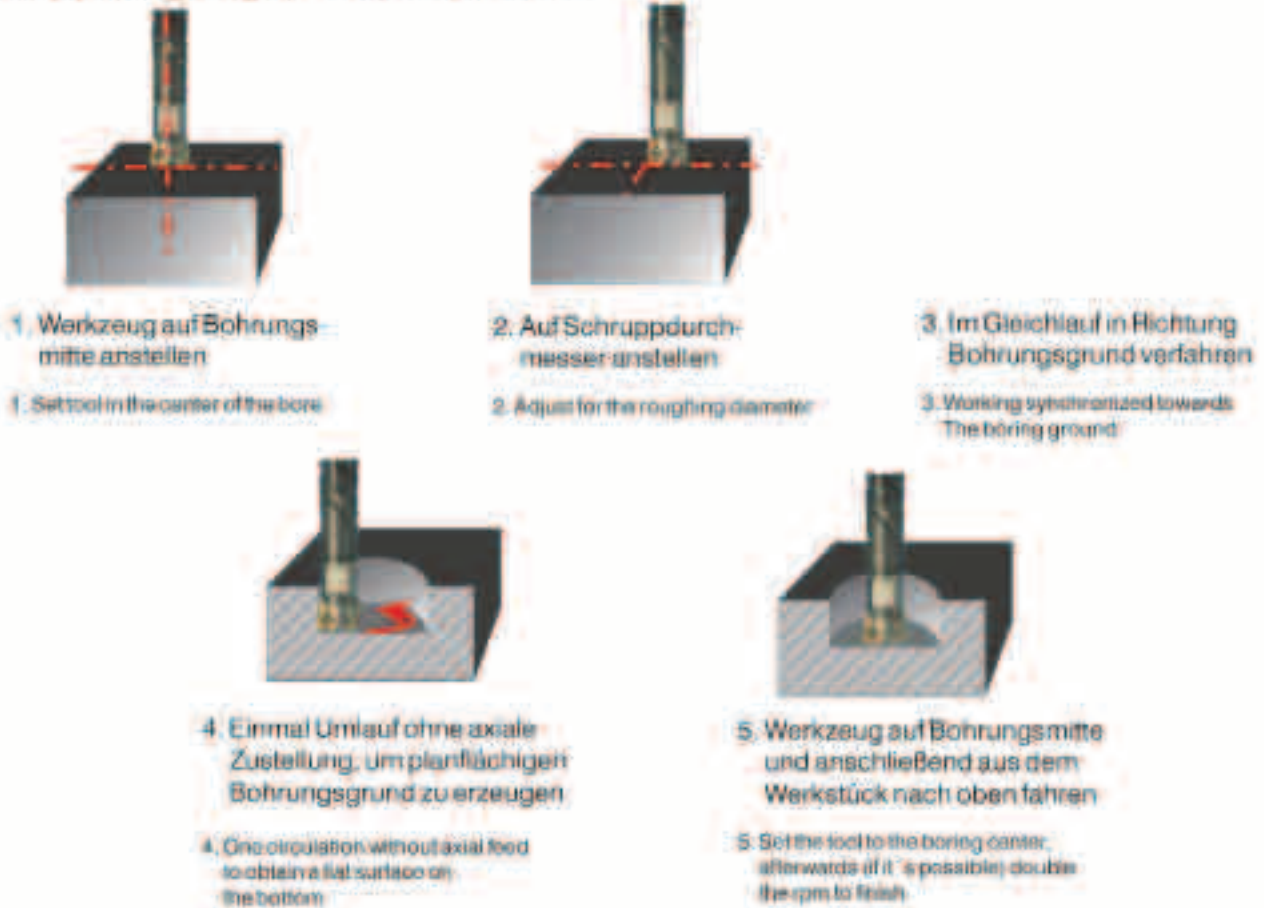

Zirkularfräser - Bahnzustellung Helixcutter - Axial adjustment / circulation

D14 bis D18:
Bahnzustellung 1,00mm - 1,50mm pro Umlauf

D23 bis D66:
Bahnzustellung 1,00mm - 2,00mm pro Umlauf

D14 to D18:
Adjustment 1,00mm - 1,50mm per circ.

D23 to D66:
Adjustment 1,00mm - 2,00mm per circ.

Bei gehärteten Stählen bis 62 HRC den K-Faktor um 50% reduzieren
With hardened steels up to HRC 62, reduce the K-factor by 50%

Zirkularfräser - Vorschubwerte fz Helixcutter - Feed rates fz

| Vc (m/min) | Alu | | | Stahl | | | | | | | | | | INOX | | GG(G) | TITAN | Graphit GFK CFK | Öl | Emulsion | MMS | Trocken | Druckluft |
|---------------|------------|-----|-------------|---------|---------|---------|----------|----------|----------|----------|----------|----------|----------|---------|---------|-------|-------|-----------------------|----|----------|-----|---------|-----------|
| | Kunststoff | Alu | Alu Guss | < 500 N | < 750 N | < 900 N | < 1100 N | < 1400 N | < 55 HRC | < 60 HRC | < 65 HRC | < 67 HRC | < 70 HRC | < 900 N | > 900 N | | | | | | | | |
| ISO-Code | N | N | N | P | P | P | P | P | H | H | H | H | H | M | M | K | S | N | | | | | |
| PTV28 | | | | | 200 | 200 | 160 | 120 | | | | | | | 100 | 80 | | | | | | | |
| PTT35 | | | | | | | 160 | 120 | | | | | | | | | | | | | | | |
| PAP28 | | | | | | | | | | | | | | | | | | | | | | | |
| MTM10 | | | | | | | | | | | | | | | | 200 | | | | | | | |
| KTE20 | 400 | 400 | 350 | | | | | | | | | | | | | | | | | | | | |
| K10 | 300 | 300 | 250 | | | | | | | | | | | | | | | | | | | | |

geeignet bedingt geeignet

Je nach Einsatzbedingung können die Schnittdaten nach oben oder nach unten korrigiert werden. Für die angegebenen Werte wird keine Haftung übernommen.
Depending on the application condition, the cutting data can be corrected upwards or downwards. For the given values no liability is assumed.

Vorschubwert fz über Fräsmittelbahn berechnen calculate the feed rate on the central milling path

Bohrungsfräsen / Bore milling

MHN 14-2
Dmin 16mm - Dmax 25mm

| Durchmesser Diameter | fz |
|-------------------------|------|
| 16 | 0,13 |
| 17 | 0,14 |
| 18 | 0,16 |
| 19 | 0,17 |
| 20 | 0,18 |
| 21 | 0,20 |
| 22 | 0,21 |
| 23 | 0,23 |
| 24 | 0,24 |
| 25 | 0,25 |

fz = Vorschub pro Zahn
Fz = feed per tooth

MHN 16-2
Dmin 20mm - Dmax 30mm

| Durchmesser Diameter | fz |
|-------------------------|------|
| 20 | 0,13 |
| 21 | 0,14 |
| 22 | 0,15 |
| 23 | 0,17 |
| 24 | 0,18 |
| 25 | 0,20 |
| 26 | 0,22 |
| 27 | 0,24 |
| 28 | 0,26 |
| 29 | 0,28 |
| 30 | 0,30 |

fz = Vorschub pro Zahn
Fz = feed per tooth

MHN 18-3
Dmin 25mm - Dmax 35mm

| Durchmesser Diameter | fz |
|-------------------------|------|
| 25 | 0,15 |
| 26 | 0,16 |
| 27 | 0,17 |
| 28 | 0,18 |
| 29 | 0,19 |
| 30 | 0,20 |
| 31 | 0,22 |
| 32 | 0,24 |
| 33 | 0,26 |
| 34 | 0,28 |
| 35 | 0,30 |

fz = Vorschub pro Zahn
Fz = feed per tooth

MHN 23-3
Dmin 30mm - Dmax 46mm

| Durchmesser Diameter | fz |
|-------------------------|------|
| 30 | 0,20 |
| 31 | 0,21 |
| 32 | 0,22 |
| 33 | 0,23 |
| 34 | 0,24 |
| 35 | 0,25 |
| 36 | 0,26 |
| 37 | 0,27 |
| 38 | 0,28 |
| 39 | 0,29 |
| 40 | 0,30 |
| 41 | 0,31 |
| 42 | 0,32 |
| 43 | 0,34 |
| 44 | 0,36 |
| 45 | 0,38 |
| 46 | 0,40 |

fz = Vorschub pro Zahn
Fz = feed per tooth

MHN 30-3
Dmin 44mm - Dmax 60mm

| Durchmesser Diameter | fz |
|-------------------------|------|
| 44 | 0,33 |
| 45 | 0,34 |
| 46 | 0,35 |
| 47 | 0,36 |
| 48 | 0,37 |
| 49 | 0,38 |
| 50 | 0,39 |
| 51 | 0,40 |
| 52 | 0,41 |
| 53 | 0,42 |
| 54 | 0,43 |
| 55 | 0,44 |
| 56 | 0,45 |
| 57 | 0,46 |
| 58 | 0,47 |
| 59 | 0,48 |
| 60 | 0,50 |

fz = Vorschub pro Zahn
Fz = feed per tooth

MHN 35-3
Dmin 54mm - Dmax 70mm

| Durchmesser Diameter | fz |
|-------------------------|------|
| 54 | 0,33 |
| 55 | 0,34 |
| 56 | 0,35 |
| 57 | 0,36 |
| 58 | 0,37 |
| 59 | 0,38 |
| 60 | 0,39 |
| 61 | 0,40 |
| 62 | 0,41 |
| 63 | 0,42 |
| 64 | 0,43 |
| 65 | 0,44 |
| 66 | 0,45 |
| 67 | 0,46 |
| 68 | 0,47 |
| 69 | 0,48 |
| 70 | 0,50 |

fz = Vorschub pro Zahn
Fz = feed per tooth

MHN 38-3

Dmin 60mm - Dmax 76mm

| Durchmesser Diameter | fz |
|-------------------------|------|
| 60 | 0,33 |
| 61 | 0,34 |
| 62 | 0,35 |
| 63 | 0,36 |
| 64 | 0,37 |
| 65 | 0,38 |
| 66 | 0,39 |
| 67 | 0,40 |
| 68 | 0,41 |
| 69 | 0,42 |
| 70 | 0,43 |
| 71 | 0,44 |
| 72 | 0,45 |
| 73 | 0,46 |
| 74 | 0,47 |
| 75 | 0,48 |
| 76 | 0,50 |

fz = Vorschub pro Zahn
Fz = feed per tooth

MHN 42-4

Dmin 68mm - Dmax 84mm

| Durchmesser Diameter | fz |
|-------------------------|------|
| 68 | 0,35 |
| 69 | 0,35 |
| 70 | 0,36 |
| 71 | 0,37 |
| 72 | 0,38 |
| 73 | 0,39 |
| 74 | 0,40 |
| 75 | 0,41 |
| 76 | 0,42 |
| 77 | 0,43 |
| 78 | 0,44 |
| 79 | 0,45 |
| 80 | 0,46 |
| 81 | 0,47 |
| 82 | 0,48 |
| 83 | 0,49 |
| 84 | 0,50 |

fz = Vorschub pro Zahn
Fz = feed per tooth

MHN 44-5

Dmin 72mm - Dmax 88mm

| Durchmesser Diameter | fz |
|-------------------------|------|
| 72 | 0,35 |
| 73 | 0,35 |
| 74 | 0,36 |
| 75 | 0,37 |
| 76 | 0,38 |
| 77 | 0,39 |
| 78 | 0,40 |
| 79 | 0,41 |
| 80 | 0,42 |
| 81 | 0,43 |
| 82 | 0,44 |
| 83 | 0,45 |
| 84 | 0,46 |
| 85 | 0,47 |
| 86 | 0,48 |
| 87 | 0,49 |
| 88 | 0,50 |

fz = Vorschub pro Zahn
Fz = feed per tooth

MHN 50-6

Dmin 84mm - Dmax 100mm

| Durchmesser Diameter | fz |
|-------------------------|------|
| 84 | 0,35 |
| 85 | 0,35 |
| 86 | 0,36 |
| 87 | 0,37 |
| 88 | 0,38 |
| 89 | 0,39 |
| 90 | 0,40 |
| 91 | 0,41 |
| 92 | 0,42 |
| 93 | 0,43 |
| 94 | 0,44 |
| 95 | 0,45 |
| 96 | 0,46 |
| 97 | 0,47 |
| 98 | 0,48 |
| 99 | 0,49 |
| 100 | 0,50 |

fz = Vorschub pro Zahn
Fz = feed per tooth

MHN 58-6

Dmin 100mm - Dmax 116mm

| Durchmesser Diameter | fz |
|-------------------------|------|
| 100 | 0,35 |
| 101 | 0,35 |
| 102 | 0,36 |
| 103 | 0,37 |
| 104 | 0,38 |
| 105 | 0,39 |
| 106 | 0,40 |
| 107 | 0,41 |
| 108 | 0,42 |
| 109 | 0,43 |
| 110 | 0,44 |
| 111 | 0,45 |
| 112 | 0,46 |
| 113 | 0,47 |
| 114 | 0,48 |
| 115 | 0,49 |
| 116 | 0,50 |

fz = Vorschub pro Zahn
Fz = feed per tooth

MHN 66-8

Dmin 116mm - Dmax 132mm

| Durchmesser Diameter | fz |
|-------------------------|------|
| 116 | 0,35 |
| 117 | 0,35 |
| 118 | 0,36 |
| 119 | 0,37 |
| 120 | 0,38 |
| 121 | 0,39 |
| 122 | 0,40 |
| 123 | 0,41 |
| 124 | 0,42 |
| 125 | 0,43 |
| 126 | 0,44 |
| 127 | 0,45 |
| 128 | 0,46 |
| 129 | 0,47 |
| 130 | 0,48 |
| 131 | 0,49 |
| 132 | 0,50 |

fz = Vorschub pro Zahn
Fz = feed per tooth

C